

# HGLT SERIES

## UHP Hand-Held

## Dump Style Control Gun

Pressures to 40,000 PSI (2750 Bar)

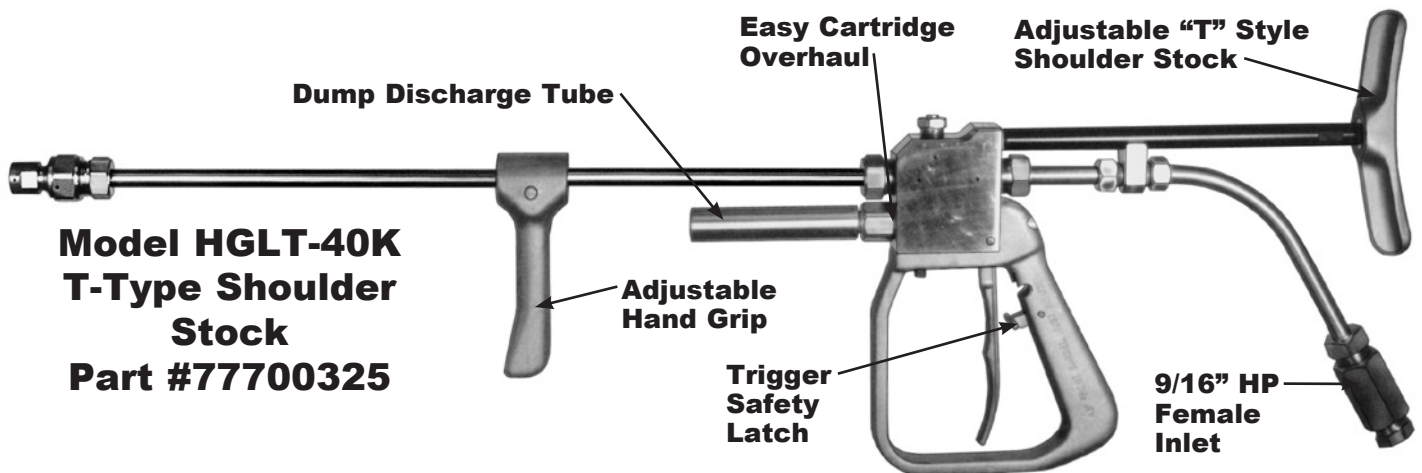

### Light, powerful and built to take punishment!

Perfect for most UHP applications. Features 60 second cartridge overhaul.

**Weights only 15.94 Lbs. (7.24 Kg) 40 KPSI (2758 Bar)**

#### Standard Features:

- Fully adjustable shoulder stocks and hand grips.
- Trigger safety latch assembly prevents accidental discharge from control gun.

### 60 Second Cartridge Overhaul

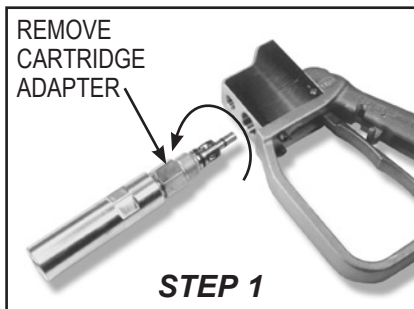

# HGLT Series Control Guns

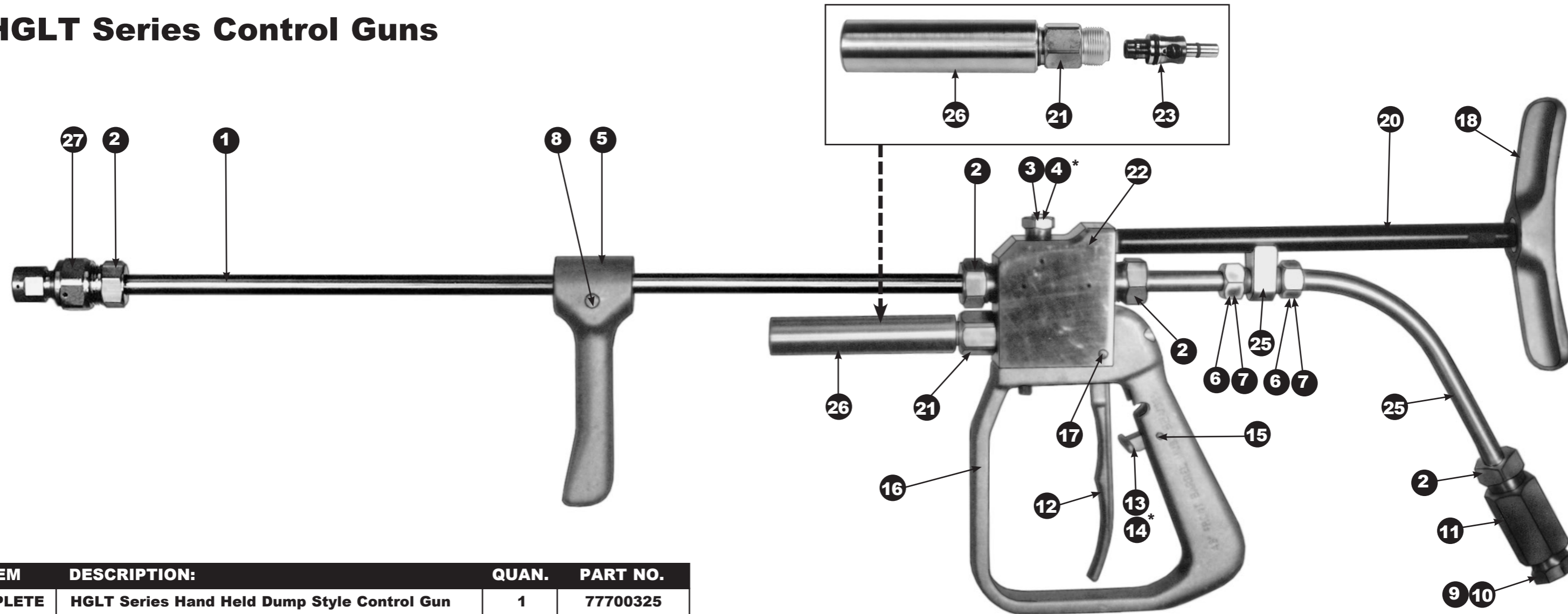

ITEM	DESCRIPTION:	QUAN.	PART NO.
<b>COMPLETE</b>	<b>HGLT Series Hand Held Dump Style Control Gun</b>	<b>1</b>	<b>77700325</b>
1	NIPPLE, 9/16" HP LH x 4' SS 40K	1	77408691
2	ANTI-VIBE COLLET ASSY. 9/16" HP	4	77513043
*3	GLAND NUT, 3/8" HP	1	77513048
*4	PLUG, 3/8" HP	1	77513050
5	HAND GRIP FRAME, 9/16" TUBE	1	77513057
6	ANTI-VIBE COLLET NUT, 9/16" MP	2	77513061-N
7	ANTI-VIBE SLEEVE, 9/16" MP	2	77513061-S
8	CAM STUD ASSEMBLY, 9/16" TUBING	1	77513063
9	COLLAR, 9/16" HP	1	77513091
10	GLAND NUT, 9/16" HP	1	77513092
11	COUPLING, 9/16" HP x 9/16" HP W/O	1	77513072-WO
12	TRIGGER, HG-SS	1	77700024
13	SAFETY LATCH, HG/HGLT	1	77700025
14	SAFETY LATCH SPRING	1	77700026
15	SAFETY LATCH PIN	1	700027

ITEM	DESCRIPTION:	QUAN.	PART NO.
16	HANDLE, 10/15K HG/HGLT	1	77700038
17	TRIGGER PIVOT PIN	1	77700045
18	T-TYPE SHOULDER STOCK, 3/8" NPT	1	77700055
19	SCREW, 1/4"-20 x 3/4" SHCS	4	77700067
20	SHOULDER STOCK EXTENSION	1	77700086
21	40K DUMP TUBE ADAPTER	1	77700304
22	HGLT 40 GUN BLOCK	1	77700306
23	40K HG/FG/DUMP TYPE CARTRIDGE	1	77700315
24	40K CLAMP BODY	1	77700316
25	INLET TUBE, 9/16" HP BENT 60°	1	77700317
26	40K DUMP TUBE, HG	1	77700320
27	NOZZLE HOLDER ASSEMBLY, 40K HGLT	1	77700326



## Safety Shrouds and Whip Hoses

Pressures to 40,000 PSI (2750 Bar)

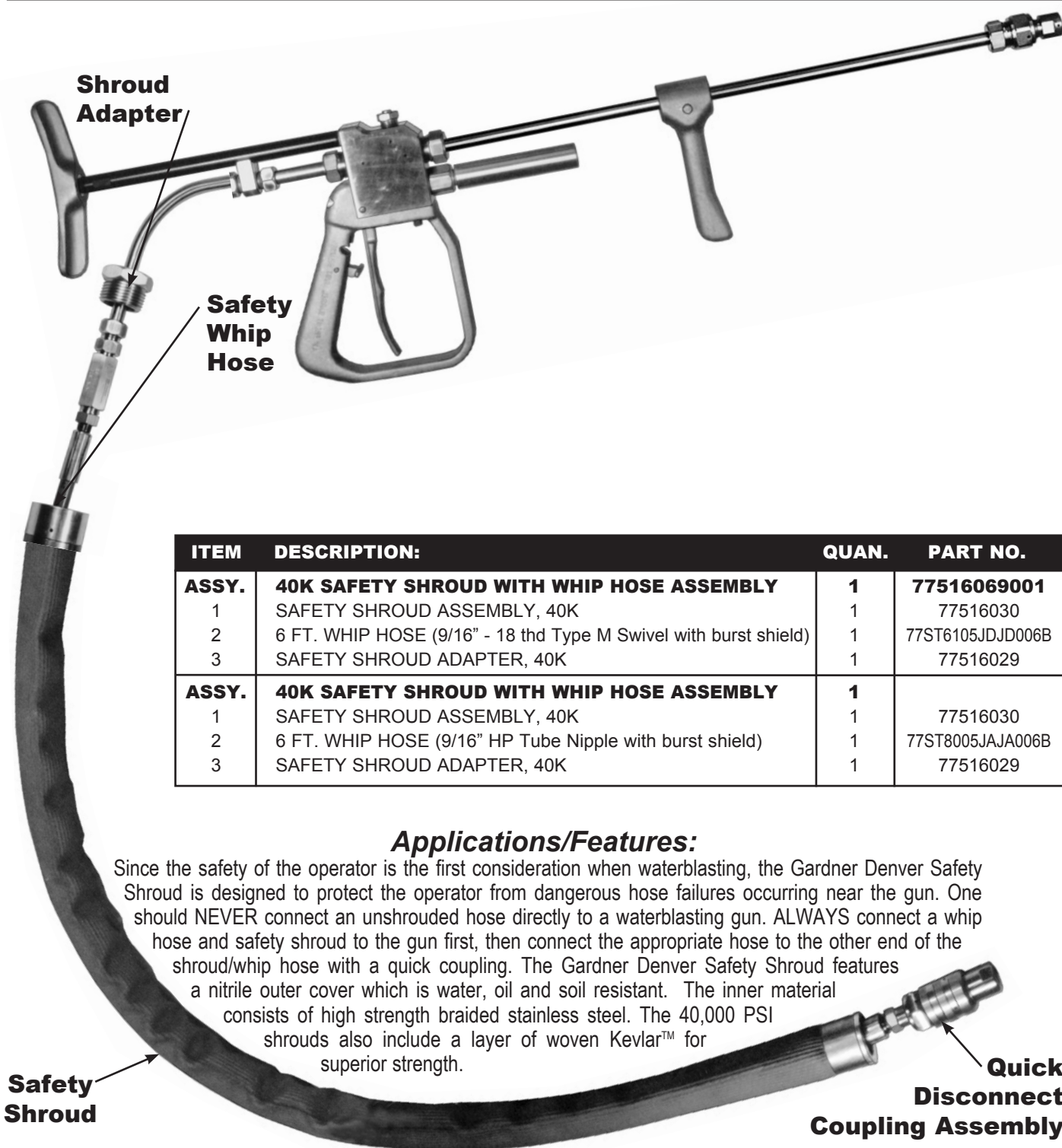

ITEM	DESCRIPTION:	QUAN.	PART NO.
<b>ASSY.</b>	<b>40K SAFETY SHROUD WITH WHIP HOSE ASSEMBLY</b>	<b>1</b>	<b>77516069001</b>
1	SAFETY SHROUD ASSEMBLY, 40K	1	77516030
2	6 FT. WHIP HOSE (9/16" - 18 thd Type M Swivel with burst shield)	1	77ST6105JDJD006B
3	SAFETY SHROUD ADAPTER, 40K	1	77516029
<b>ASSY.</b>	<b>40K SAFETY SHROUD WITH WHIP HOSE ASSEMBLY</b>	<b>1</b>	
1	SAFETY SHROUD ASSEMBLY, 40K	1	77516030
2	6 FT. WHIP HOSE (9/16" HP Tube Nipple with burst shield)	1	77ST8005AJA006B
3	SAFETY SHROUD ADAPTER, 40K	1	77516029

### Applications/Features:

Since the safety of the operator is the first consideration when waterblasting, the Gardner Denver Safety Shroud is designed to protect the operator from dangerous hose failures occurring near the gun. One should NEVER connect an unshrouded hose directly to a waterblasting gun. ALWAYS connect a whip hose and safety shroud to the gun first, then connect the appropriate hose to the other end of the shroud/whip hose with a quick coupling. The Gardner Denver Safety Shroud features a nitrile outer cover which is water, oil and soil resistant. The inner material consists of high strength braided stainless steel. The 40,000 PSI shrouds also include a layer of woven Kevlar™ for superior strength.

**Safety Shroud**

**Quick Disconnect Coupling Assembly**